

ANNUAL GIVING CAMPAIGN 2019-2020



Still
growing
strong!





35^{years} ago...

a group of families came together with a common goal: providing the best Montessori education for their children. Through the vision, effort and generosity of those first families, Omni Montessori School was founded. Thanks to the dedication of all those who have been a part of Omni over the years, today, Omni is a thriving community on two campuses, serving children ages 3 to 15 years. Now it is our turn to be the stewards of our school, ensuring that an authentic Montessori experience will continue to be available for our current families and those who come after us.



Just as at any non-profit, independent school, Omni's tuition does not fully cover all of the costs required to educate our students. The proceeds from the Annual Giving Campaign guarantee that the school's operating needs are met while allowing tuition to remain as low as possible, thereby allowing an Omni education to be available to a wide range of families.



As we launch the 2019-2020 Annual Giving Campaign, we invite you to read about Omni's journey . . .

Omni Montessori School started out in 1985 with one building holding one primary classroom and one elementary classroom. Today the school offers an authentic Montessori education to children ages 3-15 years in seven classrooms on our Blakeney campus, and a Program for Adolescents on our Waxhaw campus. We have celebrated these milestones along the way:

1985

Several families form an organization to create a new Montessori school in Charlotte. They purchase three acres in then rural South Charlotte and construct a building to open Omni Montessori Center with one Primary class and one Elementary class.



1989

Ground is broken for a second building to house the expanding elementary program. Soon thereafter, Omni establishes a Board of Trustees and a Parent Association.



1998

A third Primary classroom is added, and a new free-standing Upper Elementary building is completed, making room for a total of six classrooms (three Primary, two Lower Elementary and one Upper Elementary).



2007

Omni launches one of the nation's few Montessori programs for adolescents. A 13-acre property in Waxhaw is purchased and renovated while six students begin classes on the Blakeney campus.



2008

After years of planning and construction, the new Activity Center opens, housing a gymnasium and office space – and later, Omni's after-school programs.





2014

Omni receives full North Carolina Association of Independent Schools (NCAIS) membership and Southern Association of Independent Schools (SAIS) and AdvancED accreditation.

2015

The Gardner Family Endowment for Inclusion and Diversity is established.



2017

The Owl's Nest Treehouse Library is dedicated. The treehouse, a charming and beautiful library nestled perfectly inside the trees, was a gift from the Baudhuin family who dreamed of connecting children with both nature and reading.



2018

The Children's Nest opens, a step toward offering an all-day Montessori experience for our youngest children.

The first Campus Master Plan is completed, which offers a comprehensive vision to expand Omni's facilities to allow the school to meet the needs of children and families for years to come.

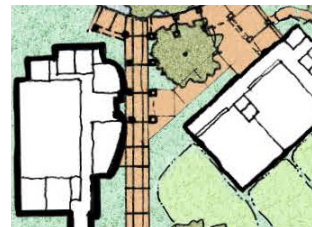

2019-2020

Omni Montessori School adopts a new mission statement: **Empowering children in a community faithful to the teachings of Maria Montessori.**

Omni celebrates its 35th Anniversary!



What's next?
It's up to us!



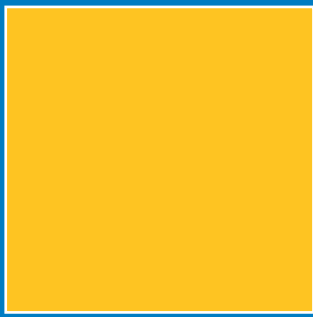

Dedication



Traditionally, we have an underlying theme that guides us throughout the year. In 2019-2020, our theme is *Dedication*, which is especially fitting as we celebrate 35 years of serving families by providing a rich Montessori education to our students.

To us, dedication means being present in the authentic work of the school and being motivated to achieve in the face of challenges. For the past 35 years, the dedication of the faculty and staff, trustees, parents and students has ensured that Omni Montessori School meets its mission: *empowering children in a community faithful to the teachings of Maria Montessori.*



35^{years}



Please
join us!





Please join us in contributing to the Annual Giving Campaign during Omni's 35th anniversary year.

With your gift, we can meet our 2019-2020 goal of \$100,000 to help:

- Maintain classrooms, facilities and grounds on both campuses
- Recruit and retain exceptional faculty and staff
- Support financial aid
- Meet budgeted expenditures not covered by tuition



We invite every member of our community — families, friends, grandparents, alumni, faculty and staff — to participate in this effort. Our goal is 100% participation from the Omni community so we may demonstrate our unequivocal support of the institution our students call home. Every gift, every dollar, makes a difference for the future of Omni.



Please fill out and return the enclosed pledge form. You can also pledge or donate online at:
www.omni-montessori.org/giving/annual_giving





Giving Levels, Recognition and Benefits

Contributors will receive listing in Omni's Annual Giving Report printed in the spring, as well as on www.omni-montessori.org/giving.

FRIENDSHIP	\$249 AND BELOW
DISCOVERY	\$250 – \$499
JOY	\$500 – \$999
CELEBRATION	\$1,000 – \$1,984

1985 Society:

In addition: Contributors to the following categories will receive a beautifully bound book commemorating Omni's 35th Anniversary, to be published in the summer.

HONOR	\$1,985 – \$4,999
RESPECT	\$5,000 – \$9,999
COMMITMENT	\$10,000 – \$24,999
PURPOSE	\$25,000 AND ABOVE

Confirmed matching gifts will count toward the total family contribution level.



For more information, please contact:

Lynn Nielsen 704.541.1326 ext. 225 lynn.nielsen@omni-montessori.org